

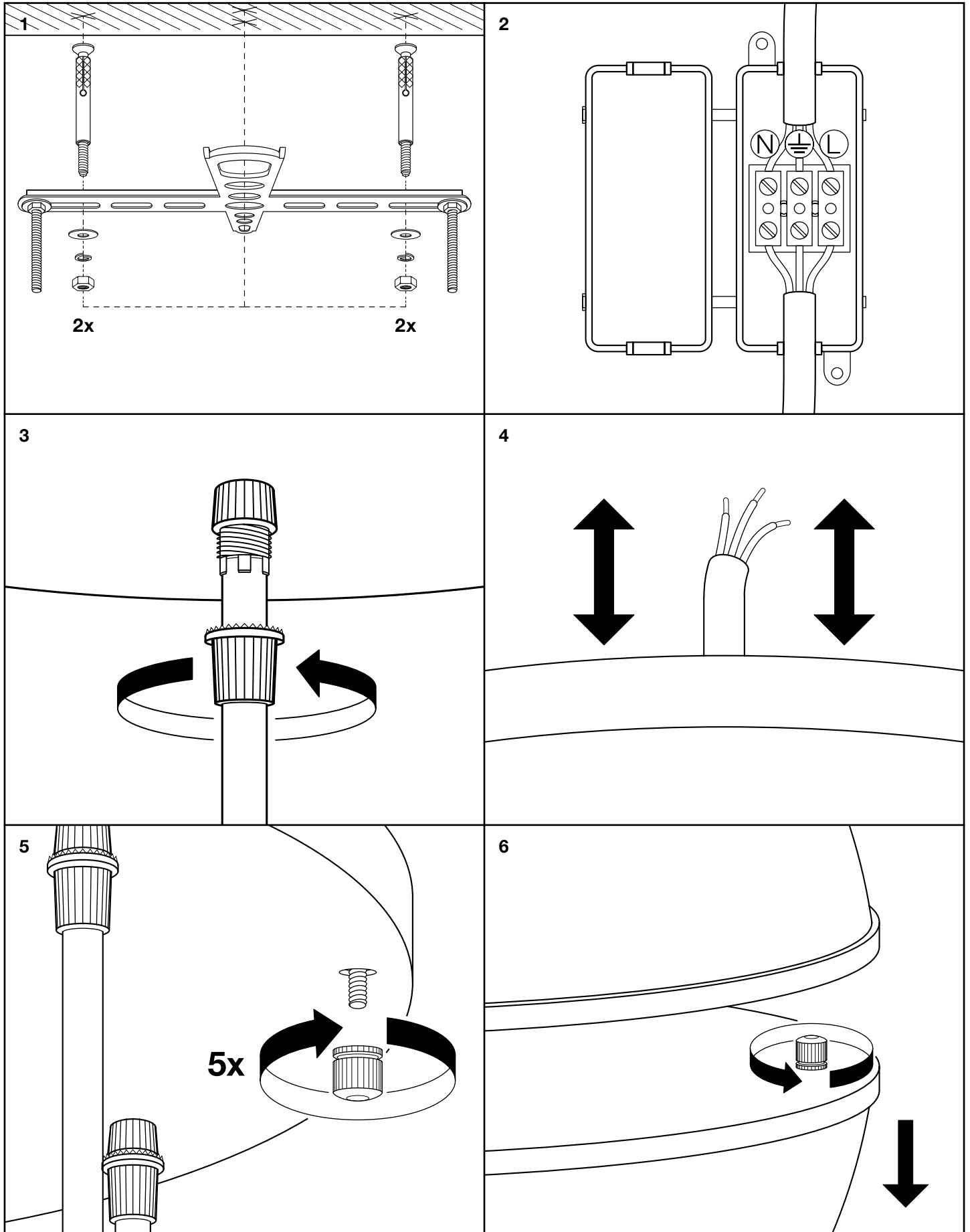

E I C H H O L T Z

112644 HANGING LAMP SPIRIDON TRIPLE

ASSEMBLY INSTRUCTION





E I C H H O L T Z

112644 HANGING LAMP SPIRIDON TRIPLE

ASSEMBLY INSTRUCTION

<p>7</p>	<p>8</p>
<p>9</p>	<p>Two people are required for safe mounting of this luminaire.</p> <ol style="list-style-type: none">1. Fix the ceiling bracket to the ceiling by using mounting plugs and screws suitable to your ceiling type and take into account the weight of your luminaire.2. Connect the 3 power wires according to their colours. Brown is the live wire, blue is the neutral wire, the green yellow wire is the earthwire.3. Loosen the plastic nut under the ceiling canopy.4. Pull the wire through until the lamp hangs at your desired height.5. Place the ceiling canopy over the ceiling plate and fix it securely with the nuts.6. Loosen the nuts of the bottom half glass and remove the glass.7. Place the bulbs and place the glass again, fix it with the nuts.8. The nuts on the top half glass are for decoration only. Loosen the threaded pipe at the top of the glass and move the glass upwards.9. Move the glass upwards to place the bulbs.10. Move the glass back to its original place, then turn the pipe clockwise to fix it securely.
<p>10</p>	